

Re-furb

ARCHITECTURE
HDT

St Barnabas Church



St Barnabas Church Mana

The demolition of aged ancillary buildings will make way for new facilities that will cater to the growing needs of this much used church. The development includes improving the existing Sanctuary. There will be a new main entrance and extended foyer capable of accommodating the congregation as they move in and out of the building and gather for fellowship. Beyond the main foyer there is a generous gallery space linking with a secondary entrance. This gallery is to provide access to a new church hall, meeting rooms, toilet facilities, children's area and administration offices.

A focal point of the new street façade is a new 40 seat chapel with internal access to the Sanctuary. All this together with increased parking, improved access and landscaping will provide the congregation and the community with a wonderful asset and become a beacon for fellowship in the area.

Re-furb

ARCHITECTURE
HDT

Thorndon NW



Thorndon New World

With an ever expanding customer base in a fast paced urban environment, Thorndon New World required an architecture that was equal amounts contemporary, cognisant of historical context, and highly efficient.

Architecture HDT responded, working closely with Foodstuffs and McKee-Fehl, with an office and produce area extension that matches crisp metallic lines with bold sculptural concrete, uniquely scaled to allow viewshafts of the historic Brew Tower to open up to the passer-by. Internally, thermally regulated zones and staff training facilities provide spaces that will help to facilitate fantastic food preparation and service well into the future.



commercial works

newsletter issue : April 2011

ARCHITECTURE
HDT

This month in our *April Newsletter* we are excited to share with you a selection of our commercial projects that are currently nearing completed documentation, under construction, or are already being used and enjoyed by our clients and the public.

This month's newsletter features a variety of commercial works; newly completed addition to Thorndon New World, the Churton Park Development, a full refurbishment and addition to St Barnabas Church in Mana and a refurbishment of the Massey Park pool complex in South Auckland.

We welcome to our ranks two new staff. *Sam Prabhakaran* completed his BArch in India in 2003. After migrating to NZ in 2007 he joined a medium sized architectural/project management firm in Palmerston North. Sam's architectural interests lie in conceptual design and the administering of contract works. *Roger Simmons* is a UK Registered Architect who moved to NZ in 2004 and has since been involved with a number of high profile Wellington projects. He had previously worked for many years at Terry Farrell's in London covering a wide range of distinctive architecture and urban design projects.



DIRECTORS

Mike Davies
Erin Tennent
Mark Bates
Geoff Glynan

ASSOCIATE

Todd Gilmore

PO Box 6435
Wellington 6141
24 Blair Street
Wellington 6011

T 04 385 2621
F 04 385 2629
E info@hdt.co.nz
W www.hdt.co.nz



Churton Park Development

HDT are delighted to be the architects for a new Retail Village development in Churton Park. Located on the corner of Westchester Drive and Lakewood Avenue, the village will create a much needed centre for the established suburb, providing various community amenities and retail outlets including a New World Supermarket. The decision to locate the retail buildings around the perimeter of the site with a centralised carpark area, aims to create a 'village square' type atmosphere, a space which could be utilised by the wider community for various outdoor events and functions. The scale of the buildings and the use of stone, stained cedar and weatherboard claddings in a 'refined rustic' aesthetic, not only provides an attractive street presence but also a sympathetic response to its surrounding residential area. The amenity that the village provides will be a welcome addition to the local community and will provide the suburb with it's own 'sense of place'.

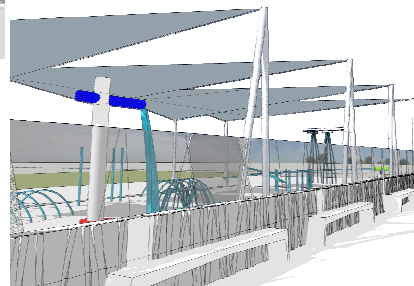
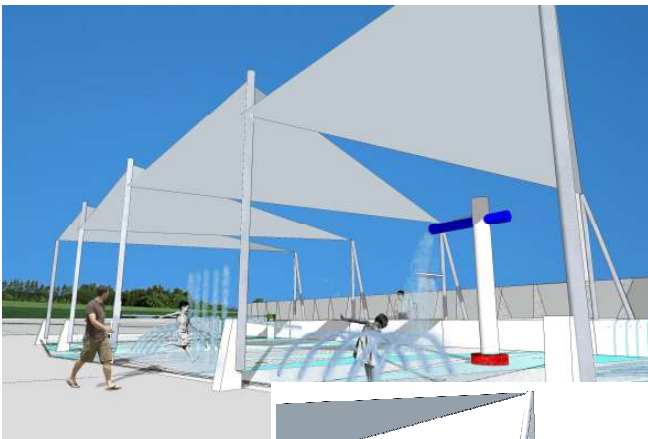

Massey Park

The upgrade of this existing facility in Papakura, Auckland, involves significant internal refurbishment work, the enhancement of existing outdoor pool areas and the addition of an outdoor Zero Depth Spray Park. Alterations to the interior will provide enhanced lighting and improvements to internal surface finishes, greatly improving the safety and cleanliness of the facility. Interchangeable water feature outlets will be provided to the interior leisure pools, allowing flexible use of water toys between these pools and the new Spray Park. The outdoor pools are considered within the community to be Papakura's 'beach'. This project significantly enhances the outdoor pool areas with improved concourse areas and the addition of the Spray Park for younger users.